

# Illustrated Index

## Transmission Housing

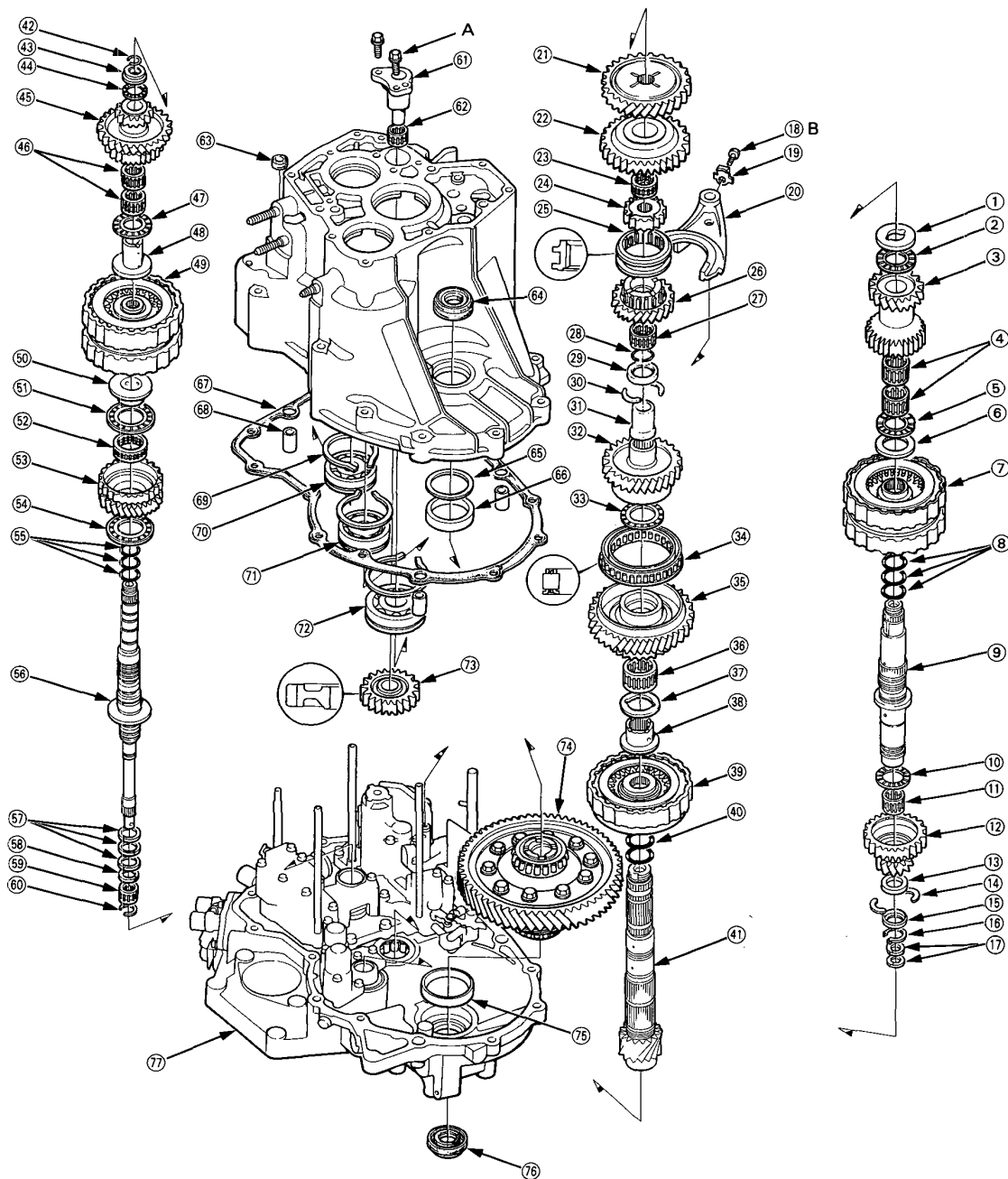



- ① THRUST WASHER
- ② THRUST NEEDLE BEARING
- ③ SECONDARY SHAFT 2ND GEAR
- ④ NEEDLE BEARING
- ⑤ THRUST NEEDLE BEARING
- ⑥ SPLINED WASHER Selective part
- ⑦ 1ST/2ND CLUTCH ASSEMBLY
- ⑧ O-RINGS Replace.
- ⑨ SECONDARY SHAFT
- ⑩ THRUST NEEDLE BEARING
- ⑪ NEEDLE BEARING
- ⑫ SECONDARY SHAFT 1ST GEAR
- ⑬ DISTANCE COLLAR, 5.0 mm
- ⑭ COTTERS, 29 mm
- ⑮ COTTER RETAINER
- ⑯ SNAP RING
- ⑰ SEALING RINGS, 32 mm
- ⑱ LOCK BOLT
- ⑲ LOCK WASHER Replace.
- ⑳ SHIFT FORK
- ㉑ COUNTERSHAFT 2ND GEAR
- ㉒ COUNTERSHAFT REVERSE GEAR
- ㉓ NEEDLE BEARING
- ㉔ REVERSE SELECTOR
- ㉕ REVERSE SELECTOR HUB
- ㉖ COUNTERSHAFT 4TH GEAR
- ㉗ NEEDLE BEARING
- ㉘ SNAP RING
- ㉙ COLLAR, 32 mm
- ㉚ COTTERS, 29 mm
- ㉛ DISTANCE COLLAR
- ㉜ COUNTERSHAFT 3RD GEAR
- ㉝ THRUST NEEDLE BEARING
- ㉞ ONE-WAY CLUTCH
- ㉟ COUNTERSHAFT 1ST GEAR
- ㊱ NEEDLE BEARING
- ㊲ THRUST WASHER
- ㊳ COUNTERSHAFT 3RD GEAR COLLAR
- ㊴ 1ST-HOLD CLUTCH ASSEMBLY

- ㊵ O-RINGS Replace.
- ㊶ COUNTERSHAFT
- ㊷ SNAP RING
- ㊸ COLLAR
- ㊹ THRUST NEEDLE BEARING
- ㊺ MAINSHAFT 4TH/REVERSE GEAR
- ㊻ NEEDLE BEARINGS
- ㊼ THRUST NEEDLE BEARING
- ㊽ 4TH GEAR COLLAR
- ㊾ 3RD/4TH CLUTCH ASSEMBLY
- ㊿ 3RD GEAR COLLAR
- ① THRUST NEEDLE BEARING
- ② NEEDLE BEARING
- ③ MAINSHAFT 3RD GEAR
- ④ THRUST NEEDLE BEARING
- ⑤ O-RINGS Replace.
- ⑥ MAINSHAFT
- ⑦ SEALING RINGS, 35 mm
- ⑧ SEALING RING, 29 mm
- ⑨ NEEDLE BEARING
- ⑩ SET RING
- ⑪ REVERSE IDLER GEAR SHAFT HOLDER
- ⑫ NEEDLE BEARING
- ⑬ OIL SEAL Replace.
- ⑭ TRANSMISSION HOUSING OIL SEAL Replace.
- ⑮ THRUST SHIM Selective part
- ⑯ BEARING OUTER RACE
- ⑰ TRANSMISSION HOUSING GASKET Replace.
- ⑱ DOWEL PIN
- ⑲ SNAP RING
- ⑳ TRANSMISSION HOUSING MAINSHAFT BEARING
- ㉑ TRANSMISSION HOUSING SECONDARY SHAFT BEARING
- ㉒ TRANSMISSION HOUSING COUNTERSHAFT BEARING
- ㉓ REVERSE IDLER GEAR
- ㉔ DIFFERENTIAL ASSEMBLY
- ㉕ BEARING OUTER RACE
- ㉖ TORQUE CONVERTER HOUSING OIL SEAL Replace.
- ㉗ TORQUE CONVERTER HOUSING

## TORQUE SPECIFICATIONS

Ref No.	Torque Value	Bolt Size	Remarks
A	12 N·m (1.2 kg-m, 9 lb-ft)	6 × 1.0 mm	
B	14 N·m (1.4 kg-m, 10 lb-ft)	6 × 1.0 mm	